

cuisiplus

ready to assemble

EBSU
EBSU INTERIEUR ET-URBAIN LTÉE.

www.ebsu.ca



LOWER CABINETS, 23 1/4" deep, without door

34 1/2" 1 door			34 1/2" 2 doors			34 1/2" 4 drawers		
WIDTH	MODEL	DOOR	WIDTH	MODEL	DOOR	WIDTH	MODEL	FACING
9"	B9	0930	24"	B24	1230	15"	BT15	1507
12"	B12	1230	27"	B27	1330	18"	BT18	1807
15"	B15	1530	30"	B30	1530			
18"	B18	1830	33"	B33	1630			
21"	B21	2130	36"	B36	1830			

34 1/2" 1 door & 1 drawer			34 1/2" 2 doors & 2 drawers			34 1/2" 2 doors & facing		
WIDTH	MODEL	DOOR	WIDTH	MODEL	DOOR	WIDTH	MODEL	DOOR
12"	BTP12	1224/1206	24"	BTP24	1224/1206	24"	BFP24	1224/2406
15"	BTP15	1524/1506	30"	BTP30	1524/1506	27"	BFP27	1324/2706
18"	BTP18	1824/1806	36"	BTP36	1824/1806	30"	BFP30	1524/3006
						33"	BFP33	1624/3306
						36"	BFP36	1824/3606

UPPER CABINETS, 11 3/4" deep, without door

30" 1 door			30" 2 doors			24" 2 doors		
WIDTH	MODEL	DOOR	WIDTH	MODEL	DOOR	WIDTH	MODEL	DOOR
9"	HG9	0930	24"	HG24	1230	24"	HM24	1224
12"	HG12	1230	27"	HG27	1330	27"	HM27	1324
15"	HG15	1530	30"	HG30	1530	30"	HM30	1524
18"	HG18	1830	33"	HG33	1630	33"	HM33	1624
21"	HG21	2130	36"	HG36	1830	36"	HM36	1824

15" 2 doors			30" blind corner 1 door			30" corner 1 door		
WIDTH	MODEL	DOOR	WIDTH	MODEL	DOOR	WIDTH	MODEL	DOOR
24"	HTP24	1215	27"	HC27	1230	24" x 24"	HC24	1630(C)
30"	HTP30	1515	30"	HC30	1530	(C) for thermoplastic door only		
33"	HTP33	1615	33"	HC33	1830			
36"	HTP36	1815	36"	HC36	2130			

To find the right code for the product of your choice, see the colour chart inside the brochure. Each colour is represented by two letters.

Example

To order a 24" microwave unit with a flame-coloured melamine finish, complete the code as follows: HMO24-FL

CABINET OPTIONS

15" for microwave		30" upper decorative		34 1/2" lower decorative		30" angle lower or upper	
WIDTH	MODEL	WIDTH	MODEL	WIDTH	MODEL	WIDTH	MODEL
24"	HMO24-__	6"	HD6-__	6"	BD6-__	12" x 24"	TRI224-__



VANITY, 20 1/4" deep, without door

30" 1 door			30" 2 doors			30" 3 drawers			30" angle 2 doors		
WIDTH	MODEL	DOOR	WIDTH	MODEL	DOOR	WIDTH	MODEL	FACING	WIDTH	MODEL	DOOR
12"	V12L	1224	24"	V24	1224	12"	VT12	1208	9"	VA9	1224
15"	V15L	1524	30"	V30	1524	15"	VT15	1508			
			36"	V36	1824						

1 fixed panel
required / P-BC-

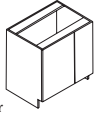

WIDTH	MODEL	DOOR
39"	BC39	1230
42"	BC42	1530
45"	BC45	1830
48"	BC48	2130

34 1/2"
corner 2 doors



WIDTH	MODEL	DOOR
33" x 33"	BC33	0930
36" x 36"	BC36	1230

34 1/2"
angle 2 doors

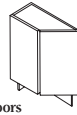

WIDTH	MODEL	DOOR
9"	BA9	1230/1530

34 1/2"
4 drawers

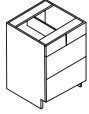

WIDTH	MODEL	FACING
30"	BT2+2	3012/1506

34 1/2"
2 drawers

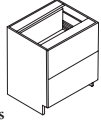

WIDTH	MODEL	FACING
30"	B30TIR	3015

PANTRY, 23 1/4" & 11 3/4" deep, without doors

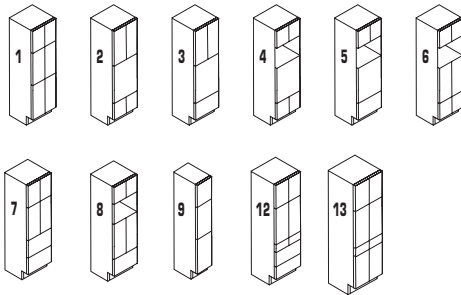

82 3/4"

MOD.	WIDTH	DEPTH	NUMBER	DOOR
GM15	15"	24"	(9) 3 doors	1518/1530
GM24	24"	24"	(1) 6 doors (6) 6 doors + microwave (13) 6 doors + drawer	1218/1230 1215/1230 1206/1218
GM30	30"	24"	(1) 6 doors (2-3-4-5-6-8) microwave and/or oven (3-5-7-8-12-13) drawer	1518/1530

Pantry sides are packaged individually.

18"
2 doors

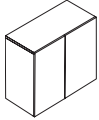

WIDTH	MODEL	DOOR
24"	HP24	1218
30"	HP30	1518

30"
wine rack

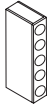

WIDTH	MODEL	DOOR
6"	HRV6	0630

30"
angle upper

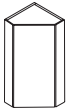

WIDTH	MODEL	DOOR
12" x 12"	HAI2-	---

DRAWER

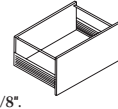

11 7/8"
ou 14 7/8".

MODEL	APPLICATION
TIR30	B30 & GM30

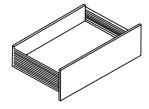

5 7/8"

MODEL	APPLICATION
TIR12	B12
TIR15	B15 & GM15
TIR18	B18
TIR12-2	B24 & GM24
TIR15-2	B30 & GM30
TIR18-2	B36

ACCESSORIES

DESCRIPTION	MODEL
Cabinet kick plate 4 1/2" x 96"	KP- ___
Vanities kick plate 5 3/4" x 96"	KPV- ___
Filler panels and light valances 2 1/2" x 96"	FIL- ___
Crown mouldings 4" x 96"	MT- ___
Light valance mouldings 2 1/2" x 96"	CL- ___

VISIBLE PANELS

DESCRIPTION	MODEL
Fixed panel for lower cabinet blind corner 27" x 30"	P-BC- ___
Fixed panel for upper cabinet blind corner 15" x 30"	P-HC- ___
Panel for back of island 48" x 34 1/2"	P-IL- ___
Panel for refrigerator 24" x 82 3/4"	P-RE- ___

VISIBLE SIDES

DESCRIPTION	MODEL
Reversible side for tall upper cabinet 11 3/4" x 30"	C-HG- ___
Reversible side for upper cabinet medium 11 3/4" x 24"	C-HM- ___
Reversible side for upper cabinet small 11 3/4" x 18"	C-HP- ___
Reversible side for upper cabinet very small 11 3/4" x 15"	C-HTP- ___
Reversible side for upper cabinet wine rack 11 3/4" x 30"	C-HRV- ___
Side for lower cabinet left and right 23 1/4" x 34 1/2"	C-B- ___ -G/D
Side for pantry left and right 23 1/4" x 82 3/4"	C-GM- ___ -G/D

MEDECINE

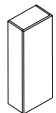

WIDTH	MODEL	DOOR
12"	PH12	1224

LIGHT CASING

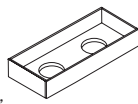

WIDTH	MODEL
24"	TL24- ___
30"	TL30- ___
36"	TL36- ___

LINEN CLOSET

Requires a V or VT
cabinet with V or
VT of 78 1/8"



3 doors

WIDTH	MODEL	DOOR
12"	L12	1224
15"	L15	1524

VISIBLE PANELS

DESCRIPTION	MODEL
Side for vanity left (G) and right (D) 20 1/4" x 29 7/8"	C-V- ___ -G/D
Side for linen closet left (G) and right (D) 20 1/4" x 78 1/8"	C-L- ___ -G/D
Reversible side for medicine cabinet 5 1/4" x 24"	C-PH- ___

*Two sides wrapped, Fibrex® backing and "H" moulding for cabinets 9" and higher.

LOWER CABINETS, 23 1/4" deep, without door

34 1/2" Double wastebasket	34 1/2" Sliding shelf with space for plumbing	34 1/2" 3 drawers	34 1/2" spice rack
WIDTH MODEL DOOR	WIDTH MODEL DOOR	WIDTH MODEL DOOR	WIDTH MODEL DOOR
18" BP18 1830	33" BEV33 1630 36" BEV36 1830	24" B3T24 2406/2412 27" B3T27 2706/2712 30" B3T30 3006/3012 33" B3T33 3306/3312 36" B3T36 3606/3612	6" BE6 E630

UPPER CABINETS, 11 3/4" deep, without door

39" 1 door	39" 2 doors	24" x 14 7/8" deep 2 doors	12" x 23 1/4" deep 1 doors
WIDTH MODEL DOOR	WIDTH MODEL DOOR	WIDTH MODEL DOOR	WIDTH MODEL DOOR
9" HTG9 0939 12" HTG12 1239 15" HTG15 1539 18" HTG18 1839 21" HTG21 2139	24" HTG24 1239 27" HTG27 1339 30" HTG30 1539 33" HTG33 1639 36" HTG36 1839	30" HMLS30 1524	33" HRE33 33H12 36" HRE36 36H12

1 fixed panel required / P-HC	39" blind corner 1 door	15" 1 swinging door	15" x 23 1/4" deep 2 doors
WIDTH MODEL DOOR	WIDTH MODEL DOOR	WIDTH MODEL DOOR	WIDTH MODEL DOOR
27" HC2739 1239 30" HC3039 1539 33" HC3339 1839 36" HC3639 2139	24" HH24 24H12 27" HH27 27H12 30" HH30 30H12 33" HH33 33H12 36" HH36 36H12	30" HTPP30 1515 33" HTPP33 1615 36" HTPP36 1815	

HH cabinets also available with inside colour.

DRAWER

	5 7/8" & 11 7/8".
MODEL APPLICATION	
TIR24-3 B24 & GM24	
TIR27-3 B27	
TIR30-3 B30 & GM30	
TIR33-3 B33	
TIR36-3 B36	

	MODEL APPLICATION
	TC1824-CR B18 TO B24 & GM24.
	TC2736-CR B27 TO B36 & GM30.

CABINET OPTIONS

39" upper decorative	18", 24" & 39" angle lower or upper	39" angle upper	39" angle 1 door	30" & 39" wine rack	without front
WIDTH MODEL DOOR	WIDTH MODEL DOOR	WIDTH MODEL DOOR	WIDTH MODEL DOOR	WIDTH MODEL DOOR	WIDTH MODEL DOOR
6" HD639-__	12" x 18" TR122418-__ 12" x 39" TR122439-__ 12" x 24" VA122124-__ (VA at 21" deep)	12" x 39" HA1239-__	24" x 24" HC2439 1639(C) (C) for thermoplastic door only Cabinets also available with inside colour.	6" HRV6F-__ 0630 6" HRV6FSF-__ 6" HRV639-__ 0639 6" HRV639F-__ 0639 6" HRV639FSF-__	

MEDECINE

WIDTH MODEL DOOR
12" PHG12 1230

PANTRY, 23 1/4" & 11 3/4" deep, without doors

15	16	REVERSIBLE	18	
OPTION LEFT ILLUSTRATED				
Available 82 3/4" (GM) or 91 3/4" (GMG) total height.				
MOD.	WIDTH	DEPTH	NUMBER	DOORS
GM1512	15"	12"	(15)	3 doors 1518/1530
GM2412	24"	12"	(16)	6 doors 1218/1230
GM24	24"	24"	(18)	4 doors + 3 drawers 1218/1230
GMA24	24"	24"	(17)	6 doors - angle 1218/1230 1618/1630
GM30	30"	24"	(18)	4 doors + 3 drawers 1518/1530

The models illustrated in the Cuisiplus PANTRY section are also available 91 3/4" high.

ACCESSOIRES

DESCRIPTION MODEL
Moulding 45° 2 1/2" X 96" OG-__

VISIBLE PANELS

DESCRIPTION MODEL
Fixed panel for very tall upper cabinet blind corner 15" x 39" P-HC39-__
Panel for refrigerator large 24" X 91 3/4" P-REG-__

VISIBLE SIDES

DESCRIPTION MODEL
*Reversible side for very tall upper cabinet 11 3/4" x 39" C-HTG-__
Reversible side for upper cabinet Reversible side for medium washer/dryer 14 7/8" x 24" C-HMLS-__
Reversible side for cabinet refrigerator 23 1/4" x 12" C-HRE-__
Reversible side for upper cabinet horizontal 11 3/4" X 15" C-HH-__
Reversible side for very small deep upper cabinet 23 1/4" X 15" C-HTPP-__
Side for pantry 12" deep left and right 23 3/4" x 82 3/4" C-GM12-__-G/D
*Side for tall pantry 24" deep left and right 23 1/4" x 91 3/4" C-GMG-__-G/D
*Side for tall pantry 12" deep left and right 11 3/4" x 91 3/4" C-GMG12-__-G/D
*Reversible side for tall medicine cabinet 5 1/4" x 30" C-PHG-__

*Two sides wrapped, Fibrex® backing and "H" moulding for cabinets 9" and higher.

EASY TO ASSEMBLE

REPLACEMENT SIDE PANELS

Remove the visible white melamine side panel(s) of bottom and or top cabinet, and replace with panel(s) of the same finish you have chosen for the doors.

Replacement side panel - Top

1. Discard white side panel.
2. Assemble with replacement side panel.

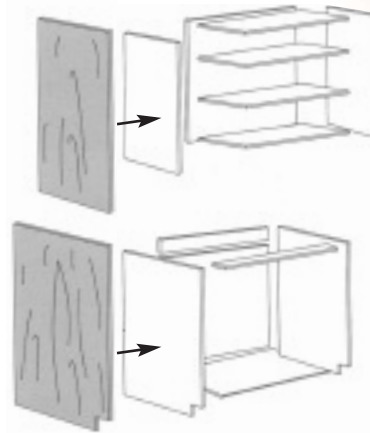

Replacement side panel - Base

CABINET ASSEMBLY

1. Insert the cam lock in the designated hole of the horizontal panel. (fig. 1)
2. Insert the assembly dowels in the designated holes of the side panel (fig. 2)
3. Slide the side panel into the base panel ensuring that the assembly dowels are well seated. (fig. 3)
4. Once the two panels have been properly adjusted, turn the camlock a quarter of a turn clockwise to lock the two panels in place. (fig. 4)

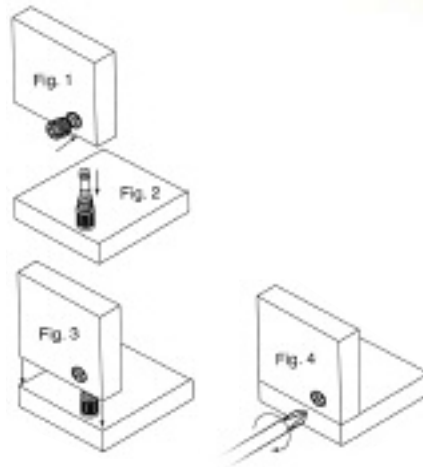

HINGE INSTALLATION

1. Insert the hinge in the designated hole of the door panel and push towards bottom. (fig. 5)
2. Insert the assembly plate in the designated holes of the side panels of the cabinet and assemble them together by a simple snap. (fig. 6)

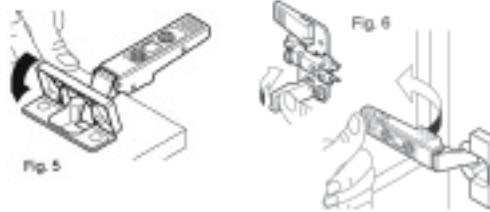

VERTICAL ADJUSTMENT



HORIZONTAL ADJUSTMENT



DEPTH ADJUSTMENT



DRAWER ASSEMBLY

1. Install the pressure bindings to the back of the drawer face and screw into place with the screws provided.
2. Install the bottom drawer panel to the sides of the drawer with the help of the predrilled holes.
3. Screw the back of drawer to the side rails.
4. Slide the two metal sides onto the binding until it locks into position.

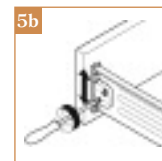
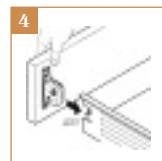
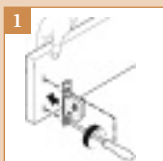

HORIZONTAL ADJUSTMENT VERTICAL ADJUSTMENT



colour

C O L L E C T I O N

MELAMINE



STANDARD
WHITE
(BL)



WHITE
WOOD GRAIN
(WG)



CANDLELIGHT
(LU)



FLAME
(FL)

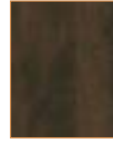

CHOCOLATE
(CO)



EBSU manufactures quality cabinets ready and easy to assemble for kitchens, bathrooms and storage areas. EBSU offers a vast array of colours and finishes, as well as new styles to help in the creation and design of your projects.

THERMOPLASTIC, JASPER



WHITE
(BLT)



WHITE
WOOD GRAIN
(TH)



CANDLELIGHT
(LUT)



FLAME
(FLT)



CHOCOLATE
(COT)



For a wider selection of door colours and styles to order, consult our 2008 Collection brochure.

C U I S I P L U S P R O D O O R S

WOOD



TRADITION



MADISON



IMPERIAL



CHATEAU

8 COLOURS AVAILABLE

- Natural Oak (CH)
- Maple (ER)
- Candlelight (LU)
- Rustic (RU)
- Bourbon (BU)
- Flame (FL)
- Cocoa (CC)
- Chocolate (CO)

*Natural oak available
in Tradition model only.*

ALUMINUM



ALISA
Aluminum frame.



www.ebsu.ca

FACTORY

109, montée Rivière des Fèves
St-Urbain-Premier (Québec) J0S 1Y0

Tel: 450 427-2687

Fax: 450 427-7150

1 877 533-7729

Fax: 1 866 315-2183

WAREHOUSE

226, rue Principale
St-Louis-de-Gonzague (Québec) J0S 1T0

Tel: 450 373-4861

Fax: 450 373-7166